

architectureBC



ABOUT THE AWARDS

The Architectural Institute of British Columbia showcases the best in architecture from the AIBC community through its awards program. While honours are given out in a number of distinct award categories, there is one common element: excellence.

PROGRAM GOALS

- To honour excellence in completed architectural projects.
- To celebrate the achievements of AIBC member architects and firms.
- To recognize the role of AIBC members and associates in the built environment.
- To encourage public interest in B.C. architects and architecture.
- To promote AIBC members as architectural leaders provincially, nationally and internationally.

AWARD CATEGORIES

Submissions are accepted in the following award categories:

THE LIEUTENANT GOVERNOR OF BRITISH COLUMBIA AWARDS IN ARCHITECTURE (“THE LGS”) – were established to recognize excellence in completed architectural projects led or designed by AIBC members. Firms, clients and lead design architects associated with chosen projects are honoured for their achievements in one of two award levels: Medal or Merit. Each eligible project submission is judged individually on how it reflects excellence in architectural design and practice.

AIBC INNOVATION AWARD – recognizes achievements that are not strictly ‘architectural,’ but that have a direct bearing on the future of architecture in such areas as design, building technology, use of materials and sustainability.

AIBC EMERGING FIRM AWARD – recognizes the development, success and contributions of emerging architectural firms. It is given to firms that have shown exemplary promise, clear vision and defined goals in the practice of architecture. It also celebrates and encourages newly-established firms that have embraced broader, modern types of practice reflecting the changing nature of the profession.

AIBC SPECIAL JURY AWARD – is a discretionary award that allows the jury to single out exceptional achievement within a project and acknowledge architecture that may be overlooked in other categories, but deserves special recognition. These projects stand out for unique, compelling and noteworthy reasons.

ABOUT THE JURY

Diligent. Thorough. Professional. Respectful. These are just a few words that describe the 2018 Architectural Awards Jury. Tasked with the challenging responsibility of selecting the worthy recipients of AIBC awards, the jury carefully reviewed nearly 60 submissions, and chose thirteen award winning projects in four categories. This year's jury (from left to right) includes:

[Diarmuid Nash](#) Architect AIBC FRAIC

[Homa Rameshg](#) Architect AIBC MRAIC

[Heba Maleki](#) Intern Architect AIBC

[Matthew Emerson](#) Architect AIBC NCARB LEED AP
Jury chair



Photo credit: Grace Battiston

LIEUTENANT GOVERNOR
OF BRITISH COLUMBIA
AWARDS IN ARCHITECTURE

“There’s a special relationship – a dialogue – between the architecture and the landscape, particularly a sense of play between the continuous linear datum versus the undulating contours of the rock-scape below.”

– Heba Maleki Intern Architect AIBC



LIEUTENANT GOVERNOR OF BRITISH COLUMBIA AWARD IN ARCHITECTURE – MEDAL

OKADA MARSHALL HOUSE

BY D'ARCY JONES ARCHITECTURE INC.

The Okada Marshall House is an ambitiously formed wood structure utilizing the shou-sugi ban technique in Sooke, B.C. The dynamic angles and spatial variety seamlessly integrate the building into its natural surroundings. All of the windows and doors point toward either the rocky landscape or Pacific Ocean, creating lively contrasts as one moves through the house.

Lead Design Architects

D'Arcy D. Jones Architect AIBC

Craig R. Bissell Architect AIBC

Client: Janice Okada & Chris Marshall

Location: Sooke, Canada

Architectural Team Member

Amanda Kemeny

Structural Engineer: Wicke Herfst Maver Structural Engineers

General Contractor: Fitchett Construction

Geotechnical Consultant: Ryzuk Geotechnical

Building Envelope Consultant: Richard Kadulski

Surveyor: Island Land Surveying

Cedar Siding and Screen Supplier: By owners w/ Warburton Woodworks

Shou Sugi Ban: By owners w/ Warburton Woodworks

Photos: Sama Jim Canzian





“The neutral white colour throughout and a continuous skylight draws in natural light, emphasizing the colour of the water, swimlane markers and the swimmers in multi-coloured gear.”

– Diarmuid Nash Architect AIBC FRAIC



LIEUTENANT GOVERNOR OF BRITISH COLUMBIA AWARD IN ARCHITECTURE – MEDAL

UBC AQUATIC CENTRE

BY MACLENNAN JAUNKALNS MILLER ARCHITECTS LTD.
AND ACTON OSTRY ARCHITECTS INC.

The UBC Aquatic Centre is a high-performance training and competition venue, as well as a community aquatic centre in the University Endowment Lands. The training facility is designed to LEED Gold standards and integrates daylighting, innovative water re-use and air quality strategies.

Lead Design Architects

Edward (Ted) K. Watson Architect AIBC OAA MRAIC SCUP
LEED AP
Viktors Jaunkalns Architect AIBC OAA FRAIC SCUP UIA
S&L WP

Client: The University of British Columbia

Location: Vancouver, Canada

Structural: Equilibrium Consulting Inc.

Mechanical: AME Consulting Group

Electrical: AES Engineering

Sustainability: Recollective

Building Code: LMDG Building Code Consultants

Building Envelope: Spratt Emanuel Engineering

Acoustics: RWDI

Landscape: PFS Studio, MJMA

Interior Design: MJMA & Acton Ostry Architects Inc.

Wayfinding: Letterbox Design, MJMA

Aquatics Consultant: MJMA, Water Technology Inc.

Commissioning: MMM Group

Civil: Kamps Engineering

Construction Management: Heatherbrae Builders

Development Manager: UBC Properties Trust

Architectural Team Members

ACTON OSTRY ARCHITECTS INC.

Mark Ostry Architect AIBC FRAIC

Russell Acton Architect AIBC FRAIC

Adam James Architect AIBC RIBA

Thomas Rooksby UK-Registered Architect ARB

MACLENNAN JAUNKALNS MILLER ARCHITECTS LTD.

Andrew Filarski Architect AIBC OAA NSAA MRAIC

Robert Allen OAA MRAIC LEED AP SCUP

J. David Miller Architect AIBC OAA NSAA FRAIC

Troy Wright OAA MRAIC

Ricardo Duque

Tarisha Dolyniuk OAA MRAIC NCIDQ ARIDO LEED AP

Darlene Montgomery OALA

Timothy Belanger

Janice Lee OAA

Kristin Beites OAA MRAIC

Aida Vatany

Danielle Lam-Kulczak

Luis Arrendondo

Photos: Ema Peter

“Thoughtful in its siting, considering greater urban strategies as well as the building's relationship to its geography through its placement, form and views.”

– Heba Malecki Intern Architect AIBC



LIEUTENANT GOVERNOR OF BRITISH COLUMBIA AWARD IN ARCHITECTURE – MEDAL

COLUMBIA VALLEY CENTRE

BY SHAPE ARCHITECTURE INC. IN JOINT VENTURE
WITH HINDLE ARCHITECTS.

The Columbia Valley Centre is a multi-use facility in the city of Invermere, B.C. Featuring a community hall and village library, the astute design of the building fulfils both the needs of the community, while also accommodating large public events.

Lead Design Architects
Alec Smith Architect AIBC
Loretta H. Kong Architect AIBC LEED AP

Client: District of Invermere
Location: Invermere, Canada

Architectural Team Members
Scott Keck Architect AIBC
Dea Knight Intern Architect AIBC
David Guenter Architect AIBC
Jesse Hindle AAA MRAIC
Dwayne Smyth Architect AIBC AAA
MRAIC
Kate Busby Architect AIBC MRAIC
Benjamin Fisher Intern Architect AIBC

Civil Engineer: Urban Systems
Electrical Engineer: Applied Engineering
Solutions
Mechanical Engineer: Rocky Point
Engineering
Structural Engineer: Read Jones
Christoffersen
General Contractor: Rendek Group
Geotechnical Consultant: McElhanny
Landscape Consultant: Navagrah
Landscape Architecture and Urban Design
Building Envelope Consultant:
Entuitive
Acoustic Consultant: BAP Acoustics
Photos: Erna Peter





“A welcome investment in a building type not usually accorded this level of design excellence.”

— Diarmuid Nash Architect AIBC FRAIC

LIEUTENANT GOVERNOR OF BRITISH COLUMBIA AWARD IN ARCHITECTURE – MERIT

SOUTH SURREY OPERATIONS CENTRE BY CARSCADDEN STOKES MCDONALD ARCHITECTS INC.

The South Surrey Operations Centre is a municipal building that blends city operations into the surrounding neighbourhood. A strategy of nesting was undertaken to integrate the Centre into the area, through protecting existing trees and undergrowth, as well as creating a new wildlife corridor.

Lead Design Architect
Glen Arden Stokes Architect AIBC

Client: City of Surrey
Location: Surrey, Canada

Architectural Team Members
Stewart Burgess Architect AIBC
Bruce Carscadden Architect AIBC
Ian Ross McDonald Architect AIBC
Jeanie Lim

Civil Engineer: R.F. Binnie & Associates
Electrical Engineer: AES Engineering
Mechanical Engineer: AME Group
Structural Engineer: Read Jones
Christoffersen
General Contractor: Graham
Construction
Geotechnical Consultant: Golder
Associates
Landscape Consultant: R.F. Binnie &
Associates
Code Consultant: Murray Johnson
Sustainability Consultant: Recollective
Consulting Inc.

Photos: Mike MacDonald, Ema Peter

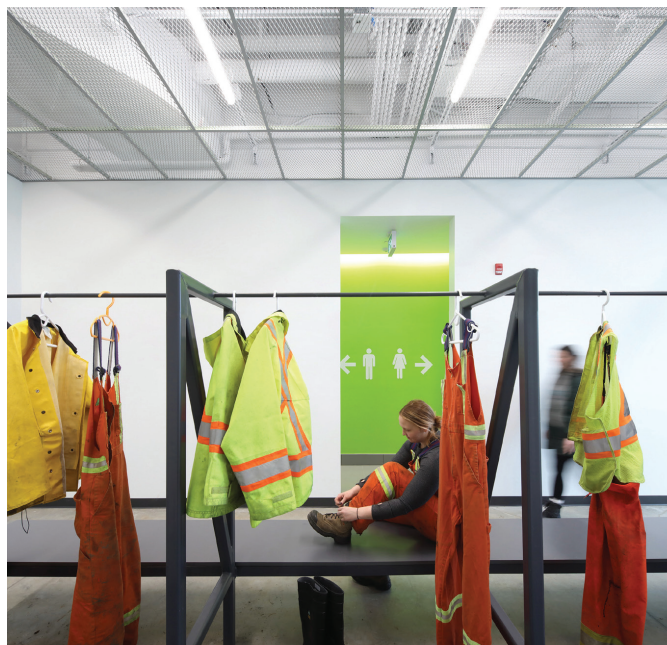



“Often a campus’ maintenance and plant buildings are hidden from view in a far off corner. Not so here, where the client pushed the team to design a building worthy of its central location.”

— Matthew Emerson Architect AIBC NCARB LEED AP

LIEUTENANT GOVERNOR OF BRITISH COLUMBIA AWARD IN ARCHITECTURE – MERIT

UNIVERSITY OF BRITISH COLUMBIA CAMPUS ENERGY CENTRE

BY DIALOG BC ARCHITECTURE ENGINEERING
INTERIOR DESIGN PLANNING INC.

The University of British Columbia's Campus Energy Centre is a state-of-the-art hot water boiler facility that provides the heating requirements for the campus. The selective use of different panel types enlivens the building's simple volume by the play of light across and through the shroud.

Lead Design Architect

Martin H. Nielsen Architect AIBC P.Eng
OAA MRAIC LEED AP

Client: University of British Columbia
Location: Vancouver, Canada

Architectural Team Members

Martin Nielsen Architect AIBC P.Eng OAA
MRAIC LEED AP

Simon J. Ellison Architect AIBC LEED
AP BD+C

John Bruce Haden Architect AIBC MRAIC
LEED AP

Chery Machan

Esteban Matthews Architect AIBC

Alicia Medina Intern Architect AIBC

Ryan McClanaghan Intern Architect AIBC

Daniel Prescott B.Eng M.A.Sc

Civil Engineer: Kerr Wood Leidal
Associates

Electrical Engineer: AES Engineering

Mechanical Engineer: FVB Energy and
AME Mechanical Consultants

Structural Engineer: Fast + EPP

General Contractor: Ledor
Construction

Landscape Consultant: Perry and
Associates Inc.

Code Consultant: LMDG Code
Consultants

Building Envelope Consultant:
Morrison Hershfield - Engineers and
Managers

Interior Design Consultant: DIALOG

Sustainability Consultant: Recollective
Consulting

Photos: Ema Peter, Robert Stefanowicz

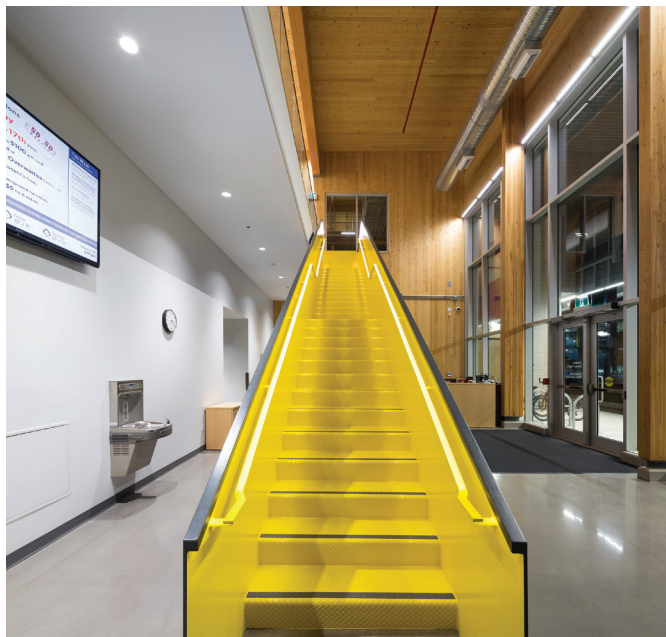

“The design of this building prevails through playful interaction between various spaces, interior openness, plenty of daylight exposure and views.”

– Homa Rameshg Architect AIBC MRAIC





LIEUTENANT GOVERNOR OF BRITISH COLUMBIA AWARD IN ARCHITECTURE – MERIT

LANGARA COLLEGE SCIENCE AND TECHNOLOGY BUILDING BY PROSCENIUM ARCHITECTURE AND INTERIORS INC. IN ASSOCIATION WITH TEEPLE ARCHITECTS INC.

The Langara College Science and Technology Building creates a gateway into the College's main campus while establishing a home for its science programs and student services. The spatial experience is defined by visual and physical interconnectivity, designed to draw students together in a collaborative environment.



Lead Design Architect
 Stephen R. Teeple Architect AIBC AAA OAA FRAIC RCA

Client: Langara College
Location: Vancouver, Canada

Architectural Team Members
 Kori Chan Architect AIBC MAAA MRAIC LEED AP
 Eric Boelling Architect OAA
 Ron Clay MRAIC
 Tomer Diamant Architect OAA
 Ben Plasche
 Richard Lam
 Kathy Chan Intern Architect AIBC
 Aidan Mitchelmore
 Gloria Perez
 Mahsa Majidian Architect OAA
 Ryan Yapyuco Architectural Technologist AIBC
 Wes Wilson Architect OAA
 Suzan Ibrahim
 Sarah Martos
 Sean Kennedy
 Avery Guthrie

Civil Engineer: Aplin Martin Consulting
Electrical Engineer: Applied Engineering Solutions
Mechanical Engineer: AME Group Consulting
Structural Engineer: Weiler Smith Bower Consulting
General Contractor: Bird Construction
Geotechnical Consultant: GeoPacific Consultants
Landscape Consultant: PFS Studio
Code Consultant: LMDG Code Consultants
Building Envelope Consultant: Reed Jones Christoffersen
Surveyor: Murray & Associates
Audio Visual Consultant: MC Squared
Furniture, Fixtures and Equipment: Heritage Office Furnishings
Construction Management: Bird Construction
Sustainability Consultant: Zon Engineering Inc.
Wayfinding Consultant: EDG Experience Design Group
Mechanical, Speciality: Thermenex
Commissioning Consultant: MMM Group
Transportation Planning Consultant: Bunt & Associates
Elevator Consultant: Gunn Consultants Inc.
Photos: Andrew Latreille



"Their design sensibility, thoughtfulness and attention to detail is what really makes their work stand out."

– Heba Maleki Intern Architect AIBC

AIBC EMERGING FIRM AWARD

LECKIE STUDIO ARCHITECTURE + DESIGN INC.

Leckie Studio Architecture + Design Inc. is an interdisciplinary design studio based in Vancouver, Canada. Their work has been nothing short of impressive since being founded in 2015. They have experienced extraordinary growth over a short period of time, and have produced a varied and exceptional collection of architectural and interior projects. Their designs are heavily informed by sustainability and collaboration. Not only does the firm have strong values and commitment to architecture, but also to the greater design community.

Principal

Michael Leckie Architect AIBC

Lead Design Architects

Dimitri James Koubatis Architect AIBC

Thomas Schroeder Architect AIBC

James Eidse Intern Architect AIBC

Emily Dovbniak OAA

Architectural Team Members

Denise Liu Interior Design Director

Guy McLintock OAA

Ashley Hannon Intern Architect AIBC

Ryan Nelson Intern Architect AIBC

Kobus Louw

Kate Read

Rina Soeda

Johnathan Lum

Matthew Joyce

Jamie Leer

Wayne Yan

Areas of Practice

Commercial, Residential, Installations and Product Design

Certificate of Practice Issued

June 2015

Project Names

1. The Backcountry Hut Company

2. Full House

3. Slack Technologies Vancouver Headquarters

Photos: Plus Visual, Leckie Studio

Architecture + Design (1 & 2);

Ema Peter (3)



“By putting on display the mechanical and biological systems that would traditionally be hidden from view, it places the public as witness and acts as a reminder of the role we each play. The community’s experience of water no longer stops when it disappears down the drain.”

– Heba Maleki Intern Architect AIBC





AIBC INNOVATION AWARD

For processes innovation and community education

SECHELT WATER RESOURCE CENTRE

BY WMW PUBLIC: ARCHITECTURE + COMMUNICATION INC.

The Sechelt Water Resource Centre rethinks traditional municipal wastewater treatment by creating a transparent space in the residential heart of Sechelt.

The facility features mechanical and biological systems that clean wastewater, encouraging the public to witness their role in the hydrological cycle.

Lead Design Architect
Brian Wakelin Architect AIBC MRAIC
LEED AP

Client: District of Sechelt
Location: Sechelt, Canada

Architectural Team Members
Chris S. Forrest Architect AIBC LEED AP
Michael R. Thicke Architect AIBC
LEED AP
John Wall Architect AIBC MRAIC LEED AP

Civil Engineer: Urban Systems
Electrical Engineer: Interior Instrument
Tech Services
Mechanical Engineer: HPF Engineering
Structural Engineer: CWMM
Consulting Engineers
General Contractor: Maple Reinders
Inc. (Design Build)
Geotechnical Consultant: Geopacific
Consultants
Landscape Consultant: Urban Systems
Code Consultant: GHL Consultants
Surveyor: Peter Gordon Land Surveying
Inc.
Process Engineering: Urban Systems
Photos: Martin Tessler

“The façade is beautiful; relating the unique directionality of the material
created in the building with the very fabric of the building’s construction.”

– Matthew Emerson Architect AIBC NCARB LEED AP



AIBC INNOVATION AWARD

For creative use of a common material

UBC QUANTUM MATTER INSTITUTE

BY WMW PUBLIC: ARCHITECTURE + COMMUNICATION
INC.

The UBC Quantum Matter Institute creates a new portal to UBC's Applied Science Precinct and serves as a new formal entrance to the Advanced Materials and Process Engineering Laboratory. Fostering collaboration, both the building's layout and materials echo the very lattice structures that are under study.

Lead Design Architect

Brian Wakelin Architect AIBC MRAIC
LEED AP

Architectural Team Members

Angela Enman Architect AIBC
Courtney Healey Architect AIBC
Laura R. Killam Architect AIBC
Susan Mavor SEG D CGD
Teresa Miller RID IDIBC LEED AP BD+C
Warren T. Scheske Intern Architect AIBC
Craig Simms Architect AIBC MRAIC
LEED AP
Michael R. Thicke Architect AIBC
LEED AP
John Wall Architect AIBC MRAIC LEED AP

Client: University of British Columbia
Properties Trust
Location: Vancouver, Canada

Electrical Engineer: MMM Group
Limited

Mechanical Engineer: Integral Group
Structural Engineer: DIALOG
Geotechnical Consultant: Geopacific
Consultants

Code Consultant: GHL Consultants
Acoustic Consultant: RWDI Air Inc.
Construction Management:
Laboratory Consultant: Argo
Architecture Inc.

Project Manager: UBC Properties Trust

Photos: Martin Tessler



“This building is innovative, bold and leading edge in showing us a glimpse of the future, of how buildings through the use of mass wood construction can contribute to the reduction of greenhouse emissions.”

– Diarmuid Nash Architect AIBC FRAIC



AIBC INNOVATION AWARD

For innovation and sustainability of mass wood construction

BROCK COMMONS TALLWOOD HOUSE

BY ACTON OSTRY ARCHITECTS INC.

Brock Commons Tallwood House is currently the tallest contemporary mass wood tower in the world. A “keep it simple” design approach was used, featuring encapsulation of the mass wood structure. Erected in only 66 days, the project’s speed, environmental benefits and cost effectiveness make it a model for future mass wood structures.

Client: University of British Columbia

Location: Vancouver, Canada

Architectural Team Members

Russell Acton Architect AIBC AAA SAA OAA

FRAIC

Mark Ostry Architect AIBC AAA SAA OAA

FRAIC

Rafael Santa Ana Architect AIBC MRAIC

Warren Schmidt Architect AIBC MRAIC

CPHD

Nebo Slijepcevic B.Arch

Nathaniel Straathof Architect AIBC LEED AP

Sergei Vakhrameev Architect AIBC

Andrew Weyrauch LEED AP CPHD

Matt Wood UK ARB MRAIC CPHD

Tall Wood Advisor: Architekten Hermann

Kaufmann ZT GmbH

Structural: Fast + Epp

Fire Science & Building Code: GHL

Consultants

Building Envelope Consultant: RDH

Building Science Inc.

Electrical, Mechanical & Sustainability:

Stantec

Energy Modeling: EnerSys Analytics Inc.

Virtual Modeling: CadMakers Inc.

Civil Engineer: Kamps Engineering

Geotechnical Consultant: Geopacific
Consultants

Landscape Consultant: Hapa Collaborative

Interior Design Consultant: Acton Ostry
Architects Inc.

Acoustic Consultant: RWDI

Audio Visual Consultant: UBC IT Audio,
Visual & Creative Services

Construction Management & Cost:
Urban One Builders

Project Manager: UBC Properties Trust

Mass Wood Supplier: Structurlam
Products LP

Mass Wood Erector: Seagate Structures

Concrete Formwork: Whitewater Concrete
Prefabricated Facade: Centura Building
Systems

Photos: Pollux Chung, Michael Elkan



“Swallowfield Barn speaks to a way of design and build that engages the power of creating architecture as a unifying community activity.”

– Diarmuid Nash Architect AIBC FRAIC





AIBC SPECIAL JURY AWARD

For community engagement

SWALLOWFIELD BARN

BY ASHER DEGROOT ARCHITECT INC.
(NOW MOTIV ARCHITECTS INC.)

Located in Langley, B.C., Swallowfield Barn used design and construction to build a sense of community within the rural area in which it resides. In the manner of traditional barn raising, the local community was involved in the creation of the structure, from the ground up. Built to last, the barn combines functionality and beauty, featuring a striking, off-kilter, roof profile that creates a warm and inviting entrance.

Lead Design Architect

Asher deGroot Architect AIBC MRAIC

Client: Jenny and Dennis DeGroot

Location: Langley, Canada

Structural Engineer: Eric Karsh, Equilibrium Consulting

General Contractor: Asher DeGroot & Dennis deGroot

General Contractor: James Munns, Create Digital Fabrication

Construction Team: Built with the help of over 60 volunteers

Photos: Ema Peter

“The building reads as a refined studio project; two simple masses interlocked, glowing as beacons in the night, with simple warm, durable interiors.”

— Matthew Emerson Architect AIBC NCARB LEED AP



AIBC SPECIAL JURY AWARD

For exceptional design clarity

THE DOCK BUILDING

BY MICHAEL GREEN ARCHITECTURE INC.

The Dock Building, located on Jericho Beach in Vancouver, serves a large marina of sailboats. The project's practical working needs, modest budget, and prominent siting required a simple solution that honoured the cannery and industrial heritage of waterfront buildings that were once found on the site a half-century before.

Lead Design Architects
Michael Green Architect AIBC
Candice Nichol Architect AIBC
Justin Bennett Architect AIBC
Client: Royal Vancouver Yacht Club
Location: Vancouver, Canada

Architectural Team Members
Mingyuk Chen
Evelyne St. Jacques
Winston Chong Architect AIBC

Civil Engineer: Worley Parsons
Electrical Engineer: Jarvis Engineering Consultants
Mechanical Engineer: AME Consulting Group
Structural Engineer: Equilibrium Consulting
General Contractor: Heatherbrae Builders
Building Envelope Consultant: RDH Building Science Inc.
Marine Structural Consultant: Worley Parsons

Photos: Ema Peter



“Crosstown Elementary is an urban school and a city innovation towards substantial environmental-social impact. The building responds to multi-stakeholders’ demands and challenges within a sustainability framework.”

– Homa Rameshg Architect AIBC MRAIC



AIBC SPECIAL JURY AWARD

For overcoming substantive obstacles to create profound social-environmental impact

CROSSTOWN ELEMENTARY SCHOOL

BY FRANCL ARCHITECTURE INC.

Located in the core of downtown Vancouver, Crosstown Elementary School is a four-storey structure for 510 K–7 children, neighbouring a public park. The design responds directly to a shift in the delivery of education in Vancouver by fitting a non-traditional building within the urban fabric of the city.

Lead Design Architect

Walter G. Franci-Uchatius Architect AIBC
AAA FRAIC LEED AP

Client: Vancouver School Board

Location: Vancouver, Canada

Architectural Team Members

Alvin Martin Architectural Technologist
AIBC

Pablo Leppe Architect AIBC

Stefan Aepli Architect AIBC MRAIC SIA
LEED AP

Mehran Parnian Architect AIBC

Electrical Engineer: MCL Engineering

Mechanical Engineer: MMM Group

Structural Engineer: Dialog (formerly
JKK)

General Contractor: ITC Construction
Group

Landscape Consultant: Durante Kreuk

Code Consultant: LMDG

Building Envelope Consultant: Dubas
Engineering

Acoustic Consultant: BKL

Photos: Michael Elkan



ST. AUGUSTINE SCHOOL
Acton Ostry Architects Inc.



LIGHT FOREST HAIR STUDIO
Arno Matis Architecture Inc.





FLOATING HOUSE
Arno Matis Architecture Inc.



APERTURE
Arno Matis Architecture Inc.

**BIRCH TREE BUILDING,
FORT ST. JOHN**
Burgers Architecture Inc.



BUCKHORN CHALET
Burgers Architecture Inc.





1001 BLANSHARD STREET
Cascadia Architects Inc.



**WEST COAST MODERN
ARCHITECTURE MEETS
RURAL LANDSCAPE**
(project included as part of
Emerging Firm submission)
Coast + Beam Architecture

CROSTOWN CONCOURSE

DIALOG BC Architecture
Engineering Interior Design
Planning Inc. and Looney
Ricks Kiss



THE NEST, AMS STUDENT UNION BUILDING, UNIVERSITY OF BRITISH COLUMBIA

DIALOG BC Architecture
Engineering Interior Design
Planning Inc. in joint venture
with B+H Architects Inc.





**EMILY CARR UNIVERSITY OF
ART + DESIGN**

Diamond and Schmitt
Architects Inc. and Chernoff
Thompson Architects



**TRADES RENEWAL AND
EXPANSION PROJECT,
OKANAGAN COLLEGE**

Diamond and Schmitt
Architects Inc. and David
Nairne & Associates Ltd.

PRIVATE RESIDENCE
2612 BELLEVUE AVE.
WEST VANCOUVER, B.C.
FNDA Architecture Inc.



BC FIREFIGHTER'S BURN
FUND CENTRE
Franci Architecture Inc.





CHANCELLOR RESIDENCE
Frits de Vries Architect Ltd.



COLLINGWOOD RESIDENCE
Frits de Vries Architect Ltd.

**TUDOR HOUSE LIQUOR
STORE**
GBL Architects Inc.



2930 CAMBIE RENOVATION
(project included as part of
Emerging Firm submission)
Haeccity Studio
Architecture, Inc.



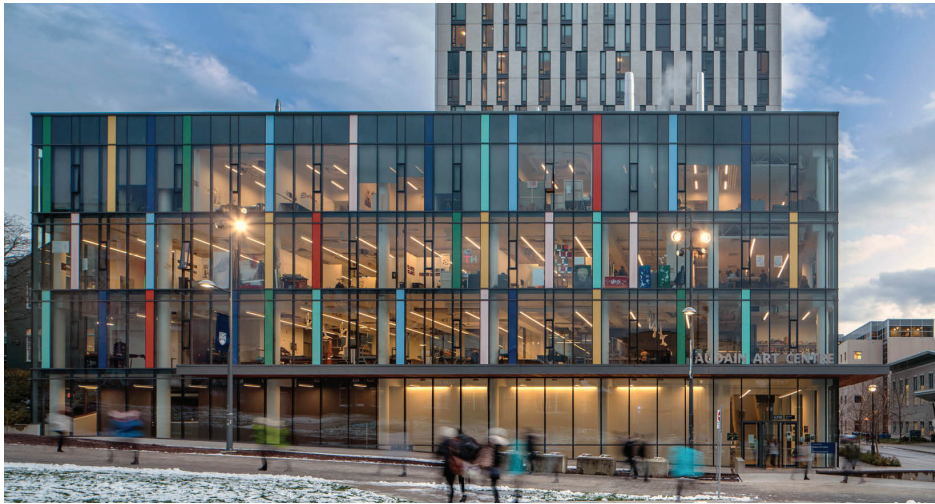

UBC PONDEROSA COMMONS
 HCMA Architecture + Design
 in joint venture with KPMB
 Architects



CEDAR ROCK
 Jason King Architect

**WILSON SCHOOL OF DESIGN
AT KWANTLEN POLYTECHNIC
UNIVERSITY**

KPMB Architects in
association with WMW
Public: Architecture +
Communication Inc.



STAPLES HOUSE
Landform Architecture Ltd.





**CREEKSIDE PADDLING
CENTRE**
McFarland Marceau Architects
Ltd.



COMBO HOUSE
Measured Architecture Inc.

WHITE LODGE
Measured Architecture Inc.



**PARALLEL 49 BREWING CO.
RESTAURANT**
Measured Architecture Inc.
in joint venture with Stuart
Howard Architects Inc.

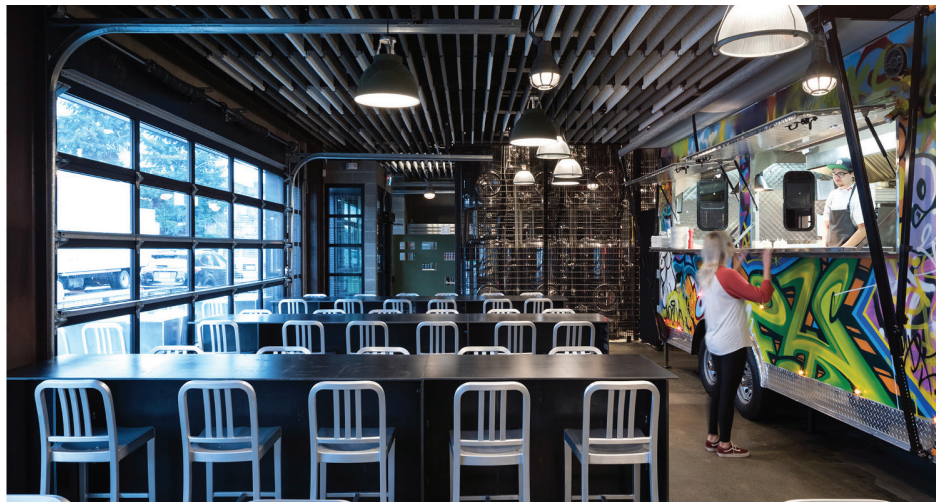



MOLSONS BANK RESTORATION

Merrick Architecture -
Borowski Sakumoto Fligg
McIntyre Ltd.



SHAW TOWER TEAHOUSE

Merrick Architecture -
Borowski Sakumoto Fligg
McIntyre Ltd. in joint venture
with Kengo Kuma &
Associates

**TAMURA HOUSE
RESTORATION**

Merrick Architecture -
Borowski Sakumoto Fligg
McIntyre Ltd.



**COAST CAPITAL
HELP CENTRE**

Musson Cattell Mackey
Partnership Architects
Designers Planners





RENFREW BUSINESS CENTRE

Musson Cattell Mackey
Partnership Architects
Designers Planners



1151 WEST GEORGIA STREET

Musson Cattell Mackey
Partnership Architects
Designers Planners in joint
venture with DYS Architecture

**GOODLIFE FITNESS FAMILY
AUTISM HUB**
NSDA Architects



**1555 WEST 8TH
RESIDENTIAL DEVELOPMENT**
Office of McFarlane Biggar
Architects & Designers Inc.





**JOYCE-COLLINGWOOD
SKYTRAIN STATION
UPGRADE**

Office of McFarlane Biggar
Architects & Designers Inc.



MARINE GATEWAY

Perkins + Will Canada
Architects Co.

ORCHARD COMMONS

Perkins + Will Canada
Architects Co.



EVERGREEN LINE STATIONS

Perkins + Will Canada
Architects Co.





MEC HEAD OFFICE
Proscenium Architecture and
Interiors, Inc.



K+K RESIDENCE
Proscenium Architecture and
Interiors, Inc.

**IQALUIT INTERNATIONAL
AIRPORT**
Stantec Architecture Ltd.



**ĀSNA?ĀM HOUSE
STUDENT RESIDENCE**
WMW Public: Architecture +
Communication Inc.





**TIMBERTRAIN COFFEE
DEPOT**

WMW Public: Architecture +
Communication Inc.



UBC BIKE SHELTER

WMW Public: Architecture +
Communication Inc.

**ADLER UNIVERSITY
VANCOUVER CAMPUS**
WMW Public: Architecture +
Communication Inc.





ARCHITECTURAL INSTITUTE OF BRITISH COLUMBIA

The Architectural Institute of British Columbia (AIBC) is an independent, professional self-governing body established in 1920 by provincial statute (the *Architects Act*) with the mandate to regulate the profession of architecture on behalf of the public.

aibc.ca

Design: Lindsay Todd

Editorial: Grace Battiston, Amanda Scott, Elizabeth Wolf, Andrew Gardiner



ARCHITECTURAL INSTITUTE OF BRITISH COLUMBIA

